



# neria™ guard infusion sets

neria™ guard is a soft cannula infusion set with an integrated insertion device for simple insertions by the touch of a button. A retractable needle may eliminate accidental needle sticks and increase insertion technique comfort.

## Product Specifications

<b>Cannula:</b>	Soft	<b>Adhesive:</b>	Built-in, skin friendly non-woven polyester, acrylic adhesive
<b>Insertion angle:</b>	90 degrees (straight in)	<b>Needle safety:</b>	Yes, passive (Needle not visible before, during and after insertion)
<b>Disconnection:</b>	Yes, at site	<b>Insertion device:</b>	Yes, incorporated in the product
<b>Introducer needle gauge:</b>	G27		
<b>Soft cannula diameter:</b>	0.68 mm (≈ G23)		

Soft cannula lengths	Tubing lengths	Priming volumes
6 and 9 mm	12, 60 and 110 cm	12 cm ~ 0.04 ml 60 cm ~ 0.10 ml 110 cm ~ 0.15 ml

The neria™ guard infusion sets are sold in boxes containing 10 pieces. Separate cannulae and tubing parts are available in boxes containing 10pcs/box.



# neria™ guard infusion set user steps

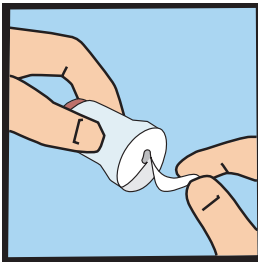

- 1.** Pull gently to remove the paper from the adhesive tape.

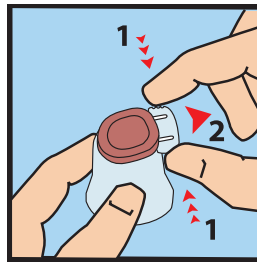

- 2.** Remove the safeguard from the insertion device by gently squeezing the sides of the safeguard and pulling it straight out.

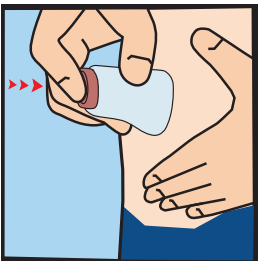

- 3.** Position the insertion device on the skin and press the red activation button completely down to insert the infusion set.

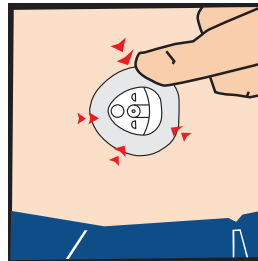

- 4.** Press the adhesive tape onto the skin.

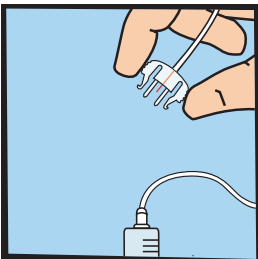

- 5.** Connect to the pump and prime the tubing according to instructions provided by the pump manufacturer.

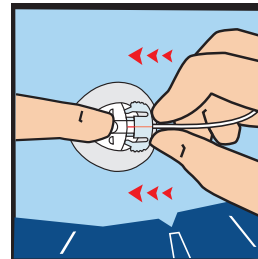

- 6.** Place a finger on the cannula housing while pushing the site connector straight in until you hear a “click”.

Please note that this guide only illustrates some of the steps to follow when inserting the neria™ guard infusion sets and it is not a substitute for reading the instructions for use which comes with the product.